

Using Google Classroom - A pupil guide:

Open up Google and click Sign in

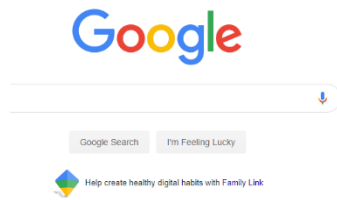

Using the username and password you have been given from school sign in to Google.

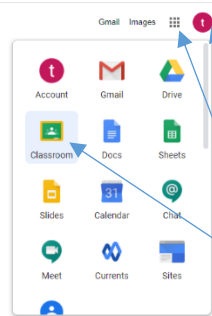
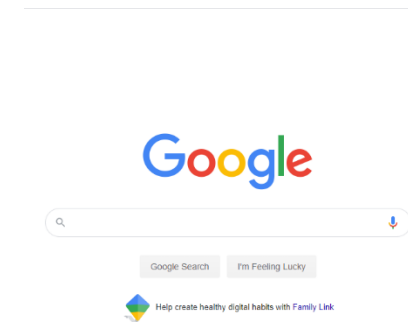
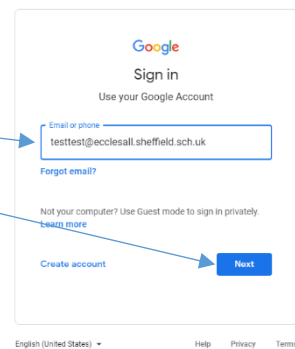

You will see your initials here.

Click on the 9 dots to get to Google Apps and click on the Classroom App

The first time you do this you will be prompted to join a classroom – click continue then click “I’m a Student”

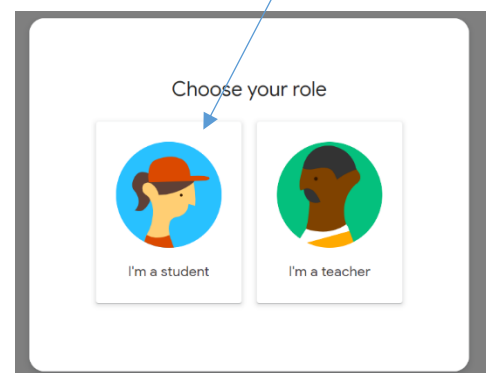
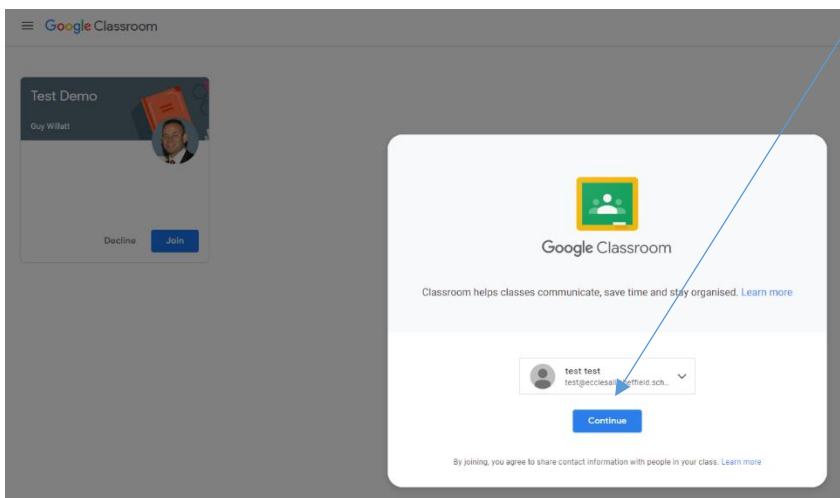

Now click Join



You will go to the "Stream" page of your Google Classroom.

Here you will find all sorts of messages and assignments.

There is also a reminder box for when things are due to be completed by.

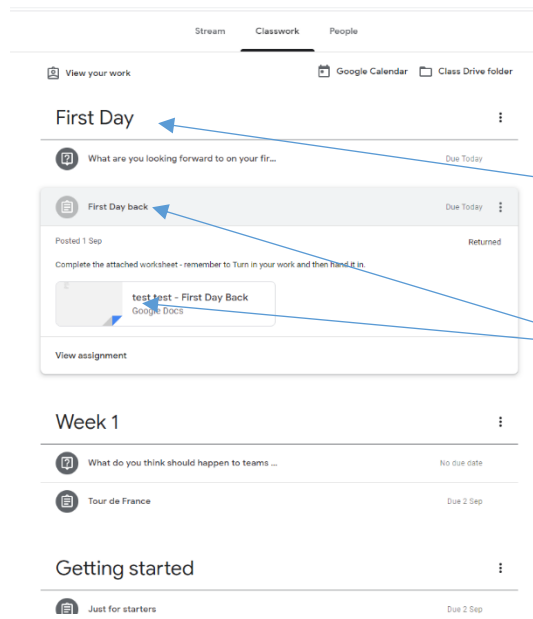
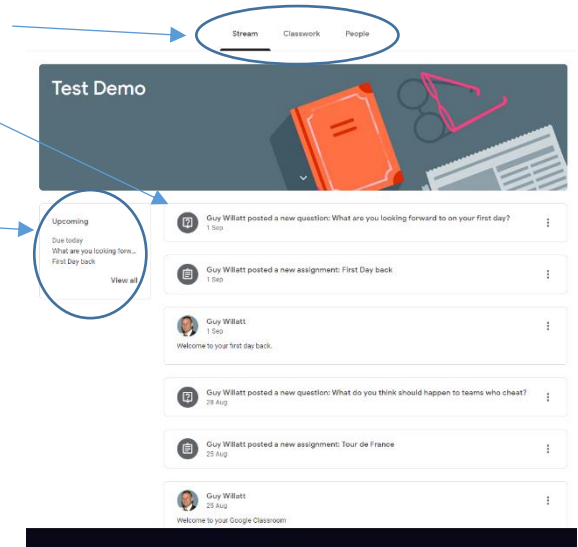

You will see work is put into "Topics" or Headings.

Click on an assignment to see instructions and any linked documents to open or complete.

If completing a task on a google doc you must TURN IN your work when you have finished it.

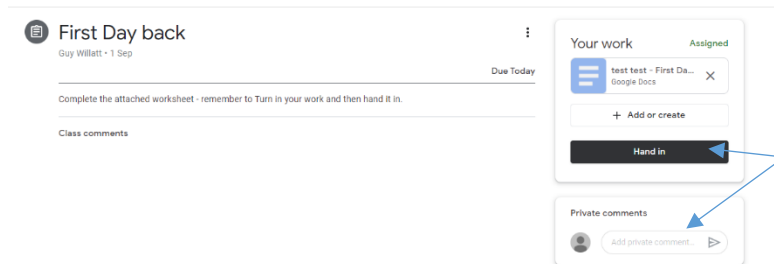
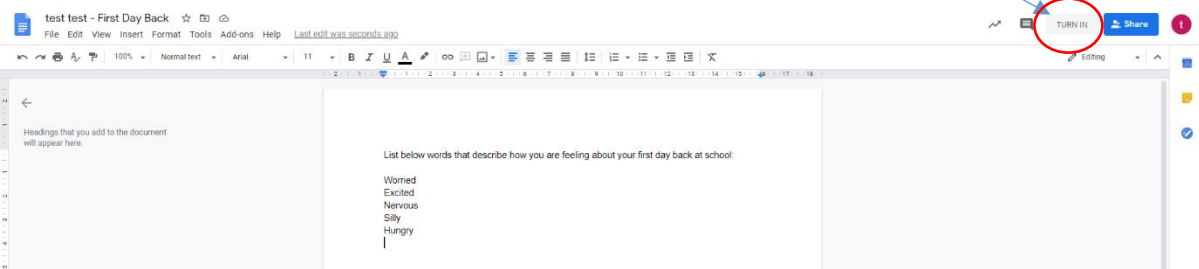

Finally, you can write a private message to your teacher if you want to and then hand in your work